

First floor (not to scale)

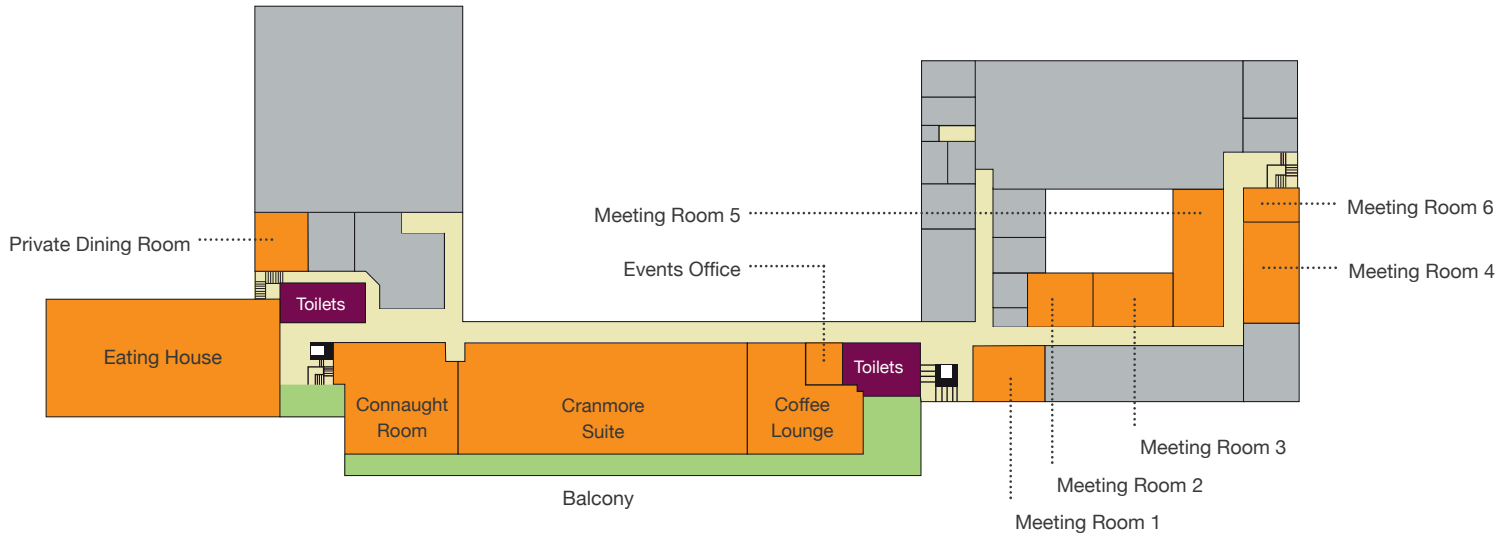

Ground floor (not to scale)

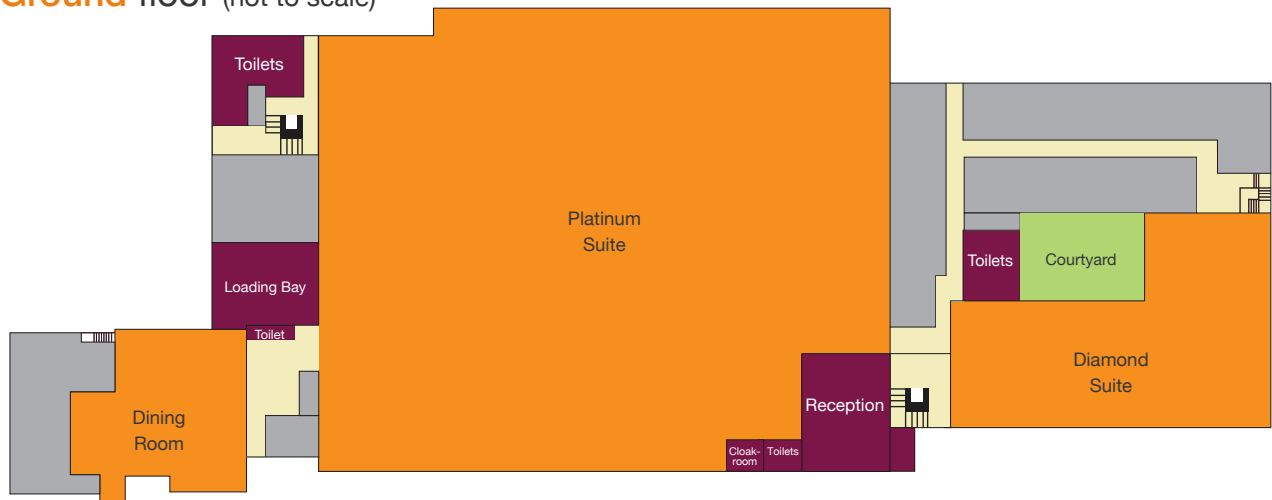

Meeting rooms and capacities

| Room | Dimensions (at its maximum) | Sq M | Max Boardroom | Max Theatre Style | Max Cabaret | Max U-Shape | Max Classroom | Level |
|------------------|-----------------------------|--------|---------------|-------------------|-------------|-------------|---------------|-----------|
| Platinum Suite | 58 x 45 m | 2445 m | N/A | 500 | 324 | N/A | 200 | Ground |
| Diamond Suite | 33.1 x 21.8 m | 508 m | 30 | 150 | 54 | 30 | 60 | Ground |
| Cranmore Suite | 29.6 x 11.4 m | 336 m | 30 | 330 | 168 | 30 | 60 | 1st Floor |
| Connaught Room | 12.8 x 11.4 m | 137 m | 30 | 120 | 48 | 30 | 24 | 1st Floor |
| Meeting Room 1* | 7.15 x 5.2 m | 37.2 m | 14 | 20 | N/A | 12 | 12 | 1st Floor |
| Meeting Room 2 | 6.5 x 5.1 m | 33.2 m | 12 | 20 | N/A | 12 | N/A | 1st Floor |
| Meeting Room 3** | 8.22 x 5.18 m | 42.6 m | 14 | N/A | N/A | N/A | N/A | 1st Floor |
| Meeting Room 4* | 10.3 x 5.2 m | 53.6 m | 20 | 40 | N/A | 18 | 16 | 1st Floor |
| Meeting Room 5* | 10.75 x 5.10 m | 54.8 m | 20 | 40 | N/A | 18 | 16 | 1st Floor |
| Meeting Room 6 | 5.33 x 3.35 m | 17.7 m | 6 | N/A | N/A | N/A | N/A | 1st Floor |

Facilities Key

- * Meeting Room has a integrated projector and screen
 - ** Meeting Room has integrated large screen T.V.
- All Meeting Rooms can be equipped with conference call facility.

Examples of typical layouts

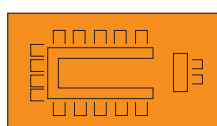

U shaped

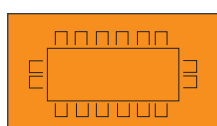

Boardroom

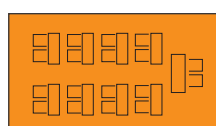

Classroom

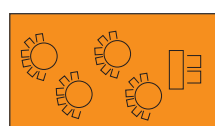

Cabaret



Theatre